

Model No.

1276 51276
1278 51278
1279 51279
1280 51280

81276
81278
81279
81280

Ages 3+

Speed Adventurer UTV

BATTERY-POWERED RIDE-ON

OWNER'S MANUAL

Please read entire manual before starting assembly and keep this manual along with your purchase receipt for future reference.



Contents, colors and decorations may vary from those shown.

⚠ WARNING:
CHOKING HAZARD-Small parts.
Not for children under 3 years.

⚠ WARNING:
Toy must be assembled by adult before use.

⚠ CAUTION
Screws contain potentially hazardous sharp points or sharp edges. Adult assembly required.

⚠ WARNING:
To reduce the risk of injury, adult supervision is required. Never use on road ways, near motor vehicles, on or near steep inclines or steps, swimming pools or other bodies of water. Always wear shoes, and never allow more than one rider.



IMPORTANT

You must charge your battery for 12 hours before you use your vehicle for the first time.

Remember to...

- ✓ Charge the battery immediately after each use.
- ✓ Charge the battery at least once a month during storage, even if the vehicle has not been used.

The battery will be permanently damaged and void your warranty if you fail to follow the instructions. Please refer to the Battery Care Section in this manual for more information.

LIMITED WARRANTY

(The warranty and customer service contact in this manual only apply in the United States and Canada)

All NPL vehicles are covered by a ninety day warranty against defects in materials or workmanship from the date of purchase from an authorized retailer. The warranty covers the NPL vehicle which has been used under normal circumstances, solely for the purpose for which it was intended and has been given proper care and maintenance. The warranty does not cover damage caused by the customer, damage which results from normal wear and tear or from alterations made by the customer, or damage caused by use for an unintended purpose. Shipping and handling are not covered by this warranty.

Please keep the original purchase receipt for any warranty claims, and inspect the product upon purchase for any defects or missing parts.

We are here to help -

- For parts, please visit: www.funcreation.net
- For Customer Service, please email us: customerservice@funcreation.net
- Or call us: 1-909-643-9359

Table of Contents

Limited Warranty	1
Important Information	2
Warning	3
Battery Warning	4
Battery Charging	5
Battery Care and Disposal	6
Parts List	7
Assembly.....	8-10
Operating your Vehicle	11
Trouble Shooting	12-13
Label Decoration	14

Important Information

- Your new vehicle requires adult assembly. Please set aside at least 30 minutes for assembly.
 - You must charge your battery for 12 hours before you use your vehicle for the first time.
We recommend that you start charging your battery before beginning assembly. Please see Battery charging section on page 5 for detailed instructions.
 - Read this manual carefully for important safety information and operating instructions before using your vehicle. Keep these instructions for future reference as they contain important information.
 - Do not operate on grass.
 - This vehicle is designed for use on: concrete, asphalt or other hard surfaces; on generally level terrain; by children ages 3 and up.
 - Instruct the children on operation and safe driving rules before they take their first drive:
 - always sit in the seat.
 - always wear shoes.
 - only one (1) rider at a time.
 - Do not place hands, feet or any part of the body, clothing or other articles near moving parts while the vehicle is in operation.
 - Do not allow other children near the car when driving.
 - Use this vehicle **ONLY** outdoors. Most interior flooring can be damaged by riding this vehicle indoors.
 - NPL will not be responsible for damage to the floor if the vehicle is used indoors.
 - To prevent damaging the motors and gears, do not tow anything behind the vehicle or overload it. Do not exceed the maximum weight capacity of 66 lbs. (30 kg).
 - If you have any questions about your KID MOTORZ vehicle, please call our service lines at **1-909-643-9359** from 9 AM to 5 PM (PST) Monday through Friday. Trained customer service representatives are available to take your call.
 - Our service centers will repair or replace parts under warranty at no extra charge, and can perform non-warranty repairs for a minimal charge.
- (The warranty and customer service contact in this manual only apply in the United States and Canada)

Warning

To Prevent Serious Injuries

- This product is intended for use by children ages 3 and up, and is not intended for children under 3 years of age due to lack of ability to operate safely.
- Maximum weight 66 lbs (30 kg). Only one rider at a time.
- Do not leave children unattended. Adult supervision required.
- This package contains small parts. Keep away from the children until assembled.
- Read manual for detailed safety information prior to use.
- Inspect product at regular intervals for wear or loose hardware and tighten as required. Remove from service if any abnormal conditions such as cracks or breaks exist.
- Check all coverings regularly to make sure they are in place.
- Batteries can fall out and injure a child if the vehicle tips over. Always use the battery cover.
- When the temperature falls below 0°F (-18°C), outdoor use of this product is not recommended.
- In extreme cold, plastic materials might lose resilience and may become brittle and crack upon impact. Store in a warmer and protected place.
- Do not operate the vehicle outdoors if it is raining. Keep it in a dry area when not in use.
- Disconnect the battery power supply when the vehicle is not in use to prevent the children driving the car without adult supervision.
- Always make sure the seat is securely attached.
- Only use the charger specified by manufacturer.
- The charger and battery are not toys and must be regularly examined for damage to the cord, plug, enclosure and other parts. In the event of damage, the damage or worn part must not be used until replaced.
- Never modify the electrical system. Use of the wrong type battery or charger could cause a fire or explosion.
- The battery compartment and area under seat are not storage areas. Storing other articles may create a fire hazard. Do not store any articles in or near motor compartment.

Safe Driving Rules

- **ADULT SUPERVISION REQUIRED. MAKE SURE CHILDREN KNOW AND FOLLOW THESE RULES FOR SAFE DRIVING.**
- Restrict children to safe riding areas:
 - Away from swimming pools and other bodies of water to prevent drowning.
 - Level ground to prevent tip over and unintended downhill motion.
 - Away from steps, hills, driveways, roads and alleys.
- Teach and learn the safety first: Although most children can master the physical driving skills to control the vehicles, they do not have the mature judgment skills. Never let a child drive at any time without adult supervision, and take the time to carefully evaluate child's skill levels and abilities to operate the vehicle safely. Children can not always recognize the hazards even after instruction. So teach appropriate safety rules before allowing any child to operate vehicle, and remember that **THERE IS NO SAFE SUBSTITUTE FOR DIRECT ADULT SUPERVISION.**
- **Riding rules :**
 - Always sit on the seat and wear shoes.
 - Only one rider at a time.
 - Do not operate in the street or near moving vehicles.
 - Do not operate near bodies of water, obstructions or drop-offs.
 - Do not operate on sand, dirt or gravel.
 - Do not operate in the dark. Unexpected obstacles could cause an accident.
 - Do not operate on inclines or steep slopes.
 - Do not operate near flammable vapors (e.g. gasoline, paint thinner, acetone, liquid wax, etc.) Using the vehicle near flammable liquids or vapors could cause an explosion or fire.
 - Do not place anything near moving parts such as motors, gears or wheels. Rotating parts can snag hair, fingers, etc., which may cause serious injury.

3

Warning

Battery Warning

ELECTRICAL HAZARD



WARNING

Battery can fall out and injure a child if vehicle tips over. Always use battery cover.

PREVENT FIRE

- Never modify the electrical system. Alterations could cause a fire resulting. In serious injury and could also ruin the electrical system.
- Use of the wrong type battery or charger could cause a fire or explosion resulting in serious injury.
- Use only components provided with products.
- Use other than provided could cause overheating, fire or explosion.
- The battery must be handled by adults only. The battery is heavy and contains sulfuric acid (electrolyte). Dropping the battery could result in serious injury.
- Never allow children to charge the battery.
- Battery charging must be done by adults only. A child could be injured by the electricity involved in charging the battery.
- Never lift or carry the battery by the wires or connector. This can damage the battery and possibly cause a fire resulting in serious injury. Lift and carry the battery by the case only.
- Read the safety instructions on the battery.
- Examine the battery, charger and their connectors for excessive wear or damage each time you charge the battery. If damage or excessive wear is detected, do not use the charger or the battery until you have replaced the worn or damaged part.



CAUTION

Only use the battery specified by manufacturer.

Only use the charger specified by manufacturer.

Only use the charger in dry locations.

About Thermal Fuses

- Your KID MOTORZ 12 volt battery is equipped with a built-in thermal fuse. The thermal fuse is a self-resetting safety device which automatically trips and shuts down operation of the vehicle if the vehicle is overloaded or the driving conditions too severe. Once a fuse has tripped it will automatically reset itself after approximately 10 seconds and allow the vehicle to resume normal operations. To avoid repeated automatic shut downs, do not overload the vehicle by exceeding the 66 lbs. (30 kg) maximum weight capacity or by towing anything behind the vehicle. Avoid severe driving conditions, such as driving up very steep slopes or running into fixed objects, which can cause the wheels to stop spinning while power is still being supplied to the motors.
- If a thermal fuse in a battery continually trips under normal driving conditions, please contact our Service Center at 1-909-643-9359.

(The warranty and customer service contact only apply in the United States and Canada.)

Important Notes

- Your new battery must be charged for at least 12 hours before you use it in your vehicle for the first time.
- You do not need to remove the battery from your vehicle to recharge it.
- The battery must be upright while charging.
- The charger is not a toy.
- Do not short circuit the battery.
- We recommend that you start charging your battery before beginning assembly of your new vehicle.
- Before charging the battery, examine the battery case for cracks and other damage which may cause sulfuric acid (electrolyte) to leak during the charging process.
- If damage is detected, do not charge the battery or use it in your vehicle. Battery acid is very corrosive and can cause severe damage to surfaces it contacts.
- Do not charge the battery on a surface which could be damaged by the acid contained inside the battery. Take precautions to protect the surface on which you charge your battery.
- If your battery is old and will not accept a charge, do not leave it in the vehicle. Always remove a dead battery from the vehicle.
- Non-rechargeable batteries are not to be recharged.
- Rechargeable batteries are only to be charged under adult supervision.
- Only batteries of the same or equivalent type as recommended are to be used.
- Batteries are to be inserted with the correct polarity.
- Exhausted batteries are to be removed from the toy.
- The supply terminals are not to be short-circuited.

Battery Charging



CAUTION

- Non-rechargeable batteries are not to be recharged.
- Make sure the charger connector is matching with the charging port.
- Make sure the brand, voltage and frequency of the charger are in accordance with the wall outlet.
- Batteries are to be connected with the correct polarity.
- The supply terminals are not to be short circuited.

5

Battery Charging

Charge the Battery

The first charge will take about 12 hours

1. Connect the battery charger.
2. Plug the charger into a standard 120V wall outlet. Note: The charger may feel warm during charging.
3. After charging is complete (at least 10-12 hours, but not more than twenty hours, with the first charge taking about 12 hours) unplug the charger from the wall outlet and unplug the charger plug from the charging port.

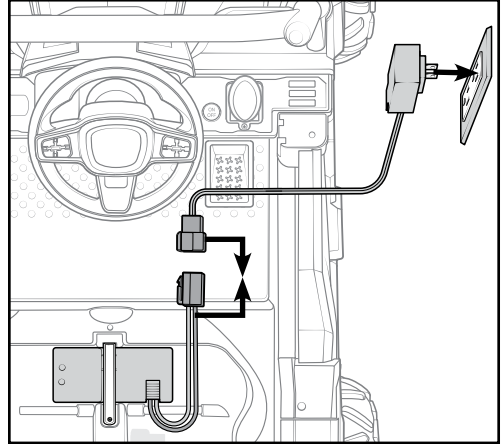

- Only use the NPL® 12 volt charger to charge your NPL® 12 volt battery.

- Note: if power flow to the wall outlet is controlled by a switch, make sure the switch is "ON".
- Before first-time use, charge the battery for at least 12 hours. Never charge the battery longer than 15 hours.
- Do not charge or store battery upside down. Charging produces explosive gases. Charge away from flames, sparks and lit cigarettes. Charge in a well ventilated area.

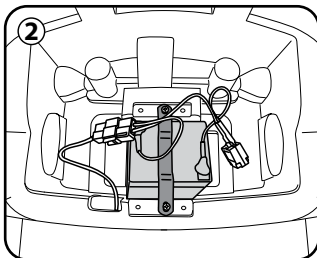
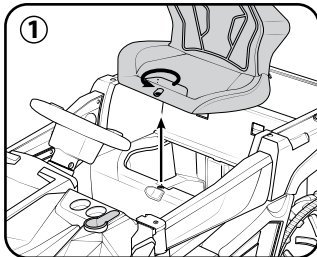

Battery replacement

- 1 - Loosen screw of the seat and remove it.
- 2 - Disconnect the socket of the battery.
- 3 - Loosen the 2 screws of the battery clamping plate.
 - Remove the clamping plate and pick up the battery.

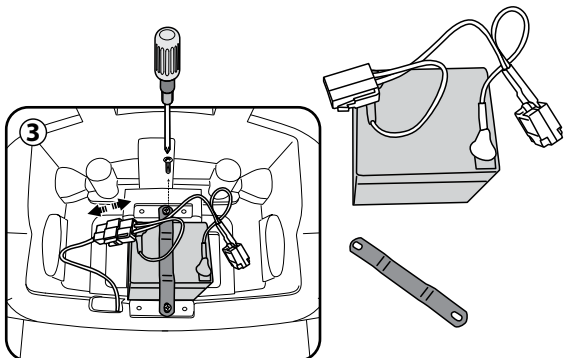

Battery Care and Disposal

Care

- If a battery leak develops, avoid contact with the leaking acid and place the damaged battery in a plastics sealed bag.
- If acid comes in contact with skin or eyes, flush with cool water for at least 15 minutes and call a physician immediately.
- If acid is internally ingested, give water, milk of magnesia or egg whites immediately. Never give emetics or induce vomiting. Call a physician immediately.
- Charge a new battery for at least 12 hours before first use.
- Never charge the battery longer than 15 hours.
- Overcharging or undercharging the battery may shorten battery life and decrease vehicle running time.
- After the first charge, recharge the battery for at least 10-12 hours after each use. Never charge the battery longer than 15 hours. Charge the battery after each use, regardless of how long the vehicle was used.
- The battery must be upright while charging.
- Do not allow the battery to run down completely before charging.
- Charge the battery before storing the vehicle.
- Charge the battery at least once per month, even if the vehicle has not been used.
- Leaving the battery in a discharged condition will ruin it.
- If the vehicle will be stored for more than two months, be sure to disconnect the motor harness from the battery.
- Do not store the battery in temperatures above 75°F or below -10°F.
- Only use 12V battery specified by manufacturer.
- Prevent the battery from moving freely inside the battery compartment. Make sure all screws for battery cover are tight.
- Examine the battery, charger and its connector for excessive wear or damage each time you charge the battery. If damage is detected, do not use the charger or the battery until you have replaced the worn or damaged part.
- Remember to remove an exhausted battery from the vehicle.
- Battery leakage and corrosion can damage the vehicle.

Disposal



- This ride on contains a sealed lead-acid battery. It must be recycled or disposed of it in an environmentally sound manner.
- Never dispose your battery in the regular, household trash. The incineration, landfilling or mixing of sealed lead-acid batteries with household trash is prohibited by law in most areas.
- To get a replacement battery, please visit your local retailer or contact at **1-909-643-9359**.
- Always remove exhausted batteries from your toy.
- Dispose of dead batteries properly. Never burn or bury them.
- Do not dispose of a lead-acid battery in a fire. The battery may explode or leak.
- Return exhausted batteries to a federal or state approved lead-acid battery recycler, such as a KID MOTORZ authorized service center, or a local seller of automotive batteries.
- For the service center, please call at **1-909-643-9359**. Contact your local waste management officials for other information regarding the environmentally sound collection, recycling and disposal of lead-acid batteries. If you live in the State of Florida or Minnesota, it is prohibited by law for anyone to throw away lead-acid batteries in the municipal waste stream.

(The warranty and customer service contact in this manual only apply in the United States and Canada.)

**TO PROLONG BATTERY LIFE,
YOU MUST RECHARGE THE BATTERY AFTER EACH USE.
YOU MUST ALSO CHARGE YOUR BATTERY
IF IT HAS NOT BEEN USED FOR 30 DAYS OR MORE.**

Parts List

- Please identify all parts before assembly and save all packaging material until assembly is completed to ensure that no parts are discarded.
- Metal parts have been coated with lubricant for protection during shipment. Wipe all metal parts with a paper towel to remove any excess lubricant.

7

Parts List

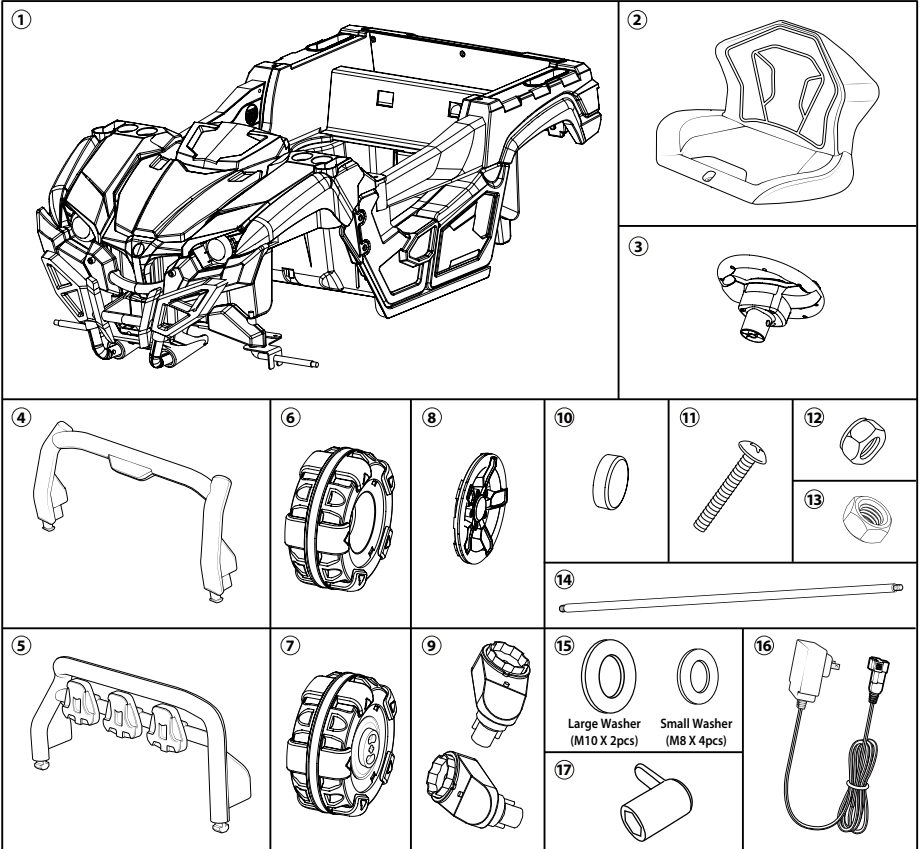

Number	Part name	Quantity
1	Vehicle body	1
2	Seat	1
3	Steering wheel	1
4	Front roll bar	1
5	Rear roll bar	1
6	Front wheel	2
7	Rear wheel	2
8	Wheel cover	4
9	Gearbox (left & right)	2

Number	Part name	Quantity
10	Wheel cap	4
11	Bolt (for Steering wheel, M5X38)	1
12	Nut (for Steering wheel, M5)	1
13	Wheel nut	4
14	Rear axle	1
15	Washer	6
16	Charger	1
17	Wrench	2

Assembly

WARNING

Children can be harmed by small parts, sharp edges and sharp points in the vehicles unassembled state, or by electrical items. Care should be taken in unpacking and assembling the vehicle. Children should not handle parts, including the battery, or help in the assembly of the vehicle.

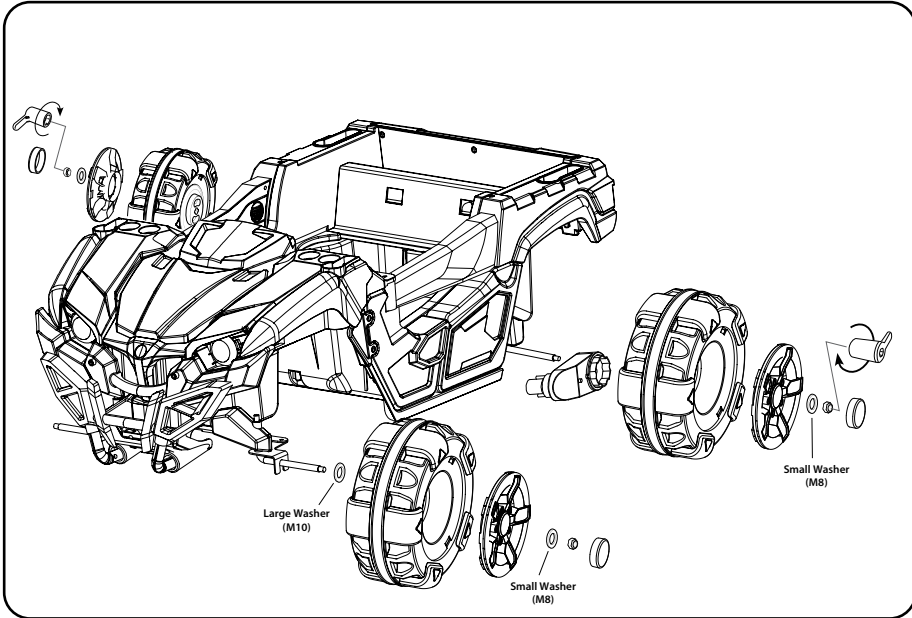

1. Front Wheels Installation

- Loosen a wheel nut and washer from the front axle.
- Slide in a large washer to the front axle.
- Insert a front wheel onto the front axle.
- Snap the wheel cover to the front wheel.
- Insert a small washer and tighten a wheel nut to the end of the front axle with a wrench.
- Snap the wheel cap into the wheel cover.
- Repeat for the other front wheel.

2. Rear Wheels Installation

- Loosen a wheel nut and washer from the rear axle.
- Insert the rear axle to the vehicle.
- Slide the gear boxes to both ends of the rear axle ("R" labeled gearbox should be fit the "R" side of the vehicle, and "L" labeled gearbox should be fit the "L" side of vehicle) with the motors pointing inward and insert them into the corresponding holes of the vehicle body. Insert the gearbox plug into the socket of the vehicle.
- Mate the sleeve of the rear driving wheel into the driving tube of the gearbox through the rear axle.
- Snap the two wheel covers to the rear wheels.
- Insert a small washer and screw in a wheel nut to both ends of the rear axle.
- Tighten the wheel nuts at both ends with a wrench simultaneously.
- Snap the wheel caps into both wheel covers.

Assembly

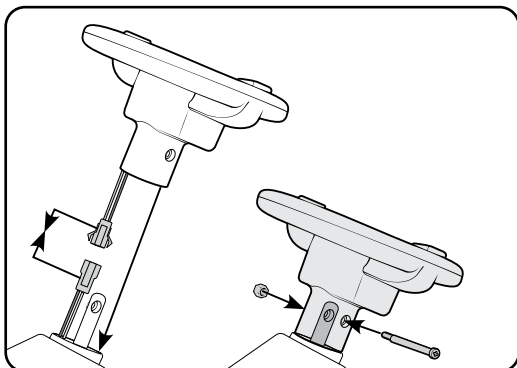

3. Steering Wheel Assembly

- Plug in the connector of the steering wheel to the socket from the dashboard's steering column.
- Loosen the M5 screw bolt from the steering wheel.
- Insert the steering wheel to the metal steering axle and align its holes to the axle's hole.
- Lock the wheel and axle with the M5 screw bolt and a M5 nut.

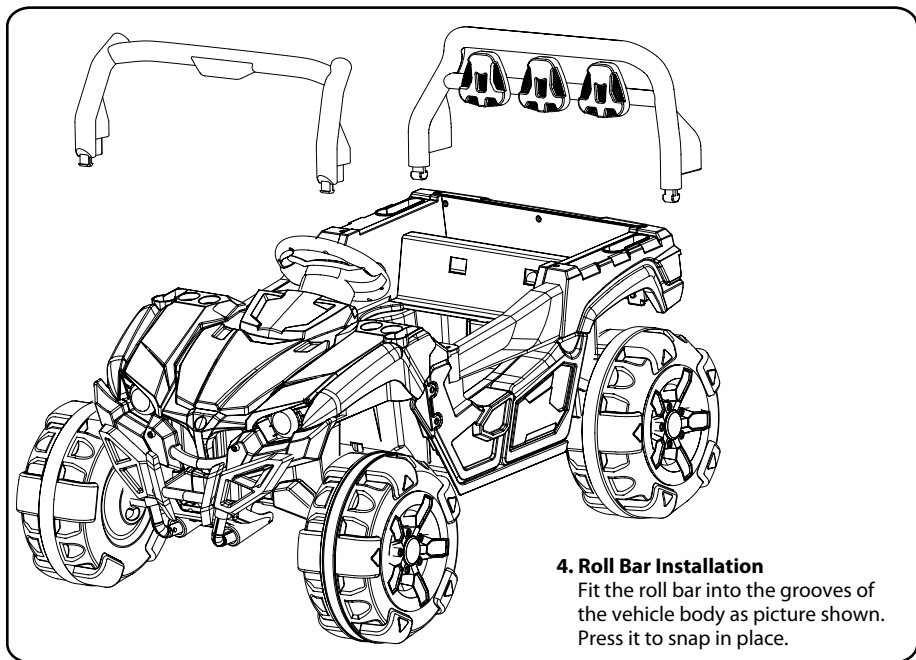

4. Roll Bar Installation

Fit the roll bar into the grooves of the vehicle body as picture shown. Press it to snap in place.

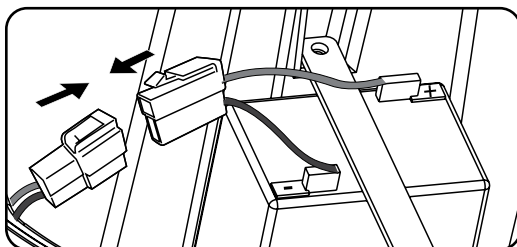

5. Battery Connection

Insert the battery plug into the socket of the vehicle within the battery compartment under the seat as the picture shown.

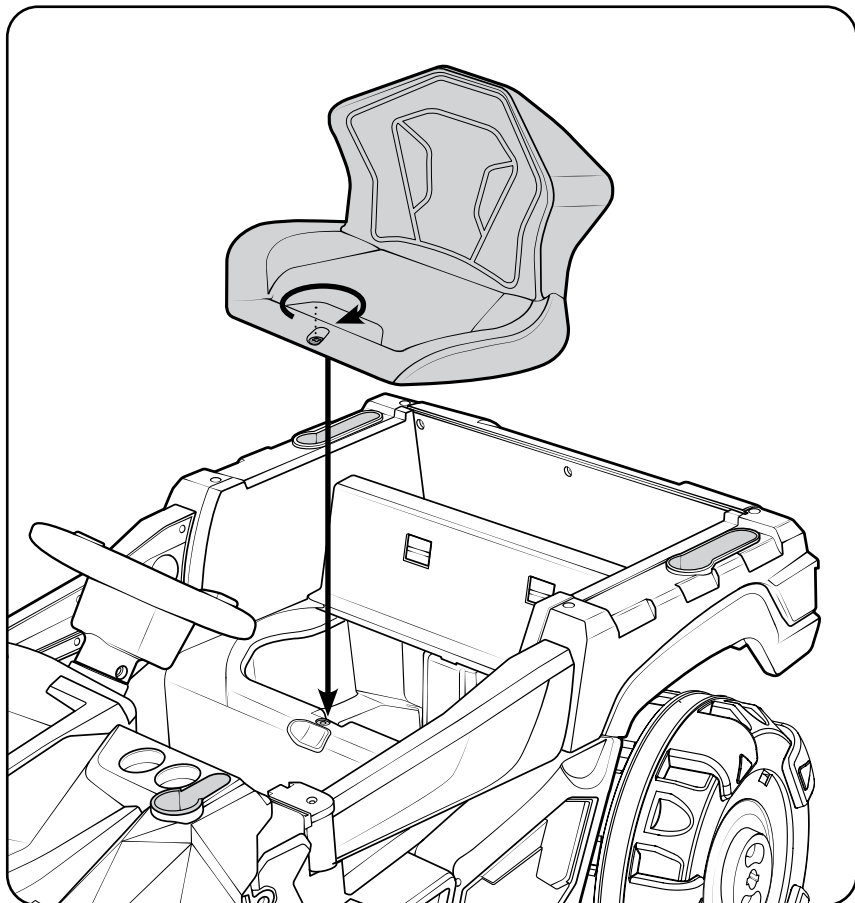

6. Seat Installation

Place the seat over the battery compartment and tighten the seat screw.

Operating Your Vehicle

11

Operating Your Vehicle

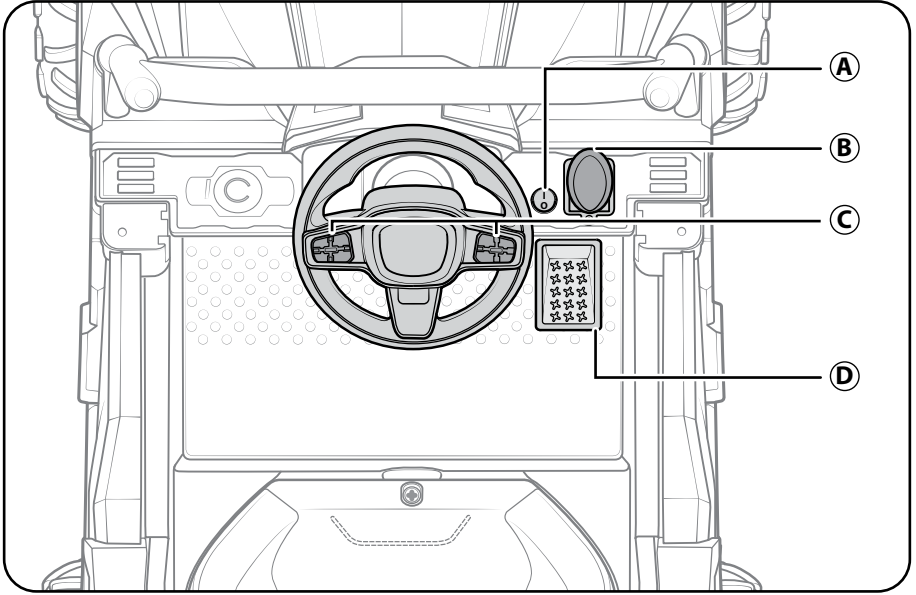

DASHBOARD:

A – Power switch

Turn the vehicle ON or OFF

B – Forward / Reverse switch

Change the forward and backward movement of the vehicle

STEERING WHEEL BUTTON:

C – Horn button

Press to play the horn sound effect

D – Foot Pedal

Press the pedal to accelerate

SEAT BELT

E – 2 point buckle

Place the right webbing's latch plate over the left latch plate, then press the combined latch plate into the buckle to fasten the seat belt.



NORMAL OPERATION

- a. Set the Forward/Reverse switch to Stop position.
- b. Turn on the power switch to start the power.
- c. Set the Forward/Reverse switch to forward position.
- d. Step on the pedal switch to start moving the vehicle forward.
- e. Stop stepping the pedal switch will stop the vehicle.
- f. Set the Forward/Reverse switch to reverse position and step on the pedal switch will move the vehicle backward.
- g. Do not set the Forward/Reverse switch when the vehicle is moving in order to protect the gear boxes.
- h. Turning the steering wheel to turn the vehicle left or right accordingly.
- i. When the vehicle is not be used, please set the power switch to "OFF" and set the Forward/Reverse switch to "Stop" position.

Trouble Shooting

IMPORTANT! If you experience a problem with your vehicle, first check the Problems and Solutions Guide below. If you still experience a problem, please contact our Service Center, at **1-909-643-9359** from 9 AM to 5 PM (PST) Monday through Friday. Or email us **customerservice@funcreation.net** or visit us **www.funcreation.net** for assistance and information from our trained technical staff.

Problem	Possible Cause	Solution
Car does not move	Circuit breaker tripped	Circuit breaker may "trip" and stop the vehicle if it is overloaded or the driving conditions too severe. The breaker will automatically reset after approximately 10 seconds, and the vehicle will operate normally. To avoid repeated automatic shut downs, do not overload the vehicle by exceeding the weight limited of 30kg (66 lbs). Or by towing anything behind the vehicle. Do not drive up hills or run into fixed objects, which can cause the wheels to stop spinning while power is still being supplied to the motors. If breaker continually trips, please contact our Service Center.
	Loose wire or connectors	Check all wires and connectors. Make sure that the motor harness connector is plugged in tightly to the battery, and that there are no loose wires around the motor.
	Dead battery	An old or improperly cared battery may be dead. If you are unsure whether it is dead or not, you can have it tested at our Service Center.
	Undercharged battery	A new battery should have been charged for at least 12 hours before using the vehicle for the first time. After that, it must be recharge the battery for at least 10-12 hours after each use. Never charge longer than 15 hours. Check all connectors; make sure the charger is plugged into the wall. Make sure the power flow to the outlet is on.
	Charger is not working	You must have a volt meter in order to tell whether the charger is working or not. If you think there maybe a problem with the charger, take it to the our Service Center where they will test it for you.
	Damaged switch	When exposed to water or moisture, switches can become corroded, or can jam due to loose dirt, sand or gravel. Please contact our Service Center for diagnosis and repair.
Car was running but suddenly stopped	Loose wire or connectors	Check all wires and connectors. Make sure that the motor harness connector is plugged into the battery tightly, and that there are no loose wires around the motor.
	Circuit breaker tripped	Circuit breaker may "trip" and stop the vehicle if it is overloaded or the driving conditions too severe. The breaker will automatically reset after approximately 10 seconds, and the vehicle will operate normally. To avoid repeated automatic shutdowns, do not overload the vehicle by exceeding the weight limited of 30kg (66 lbs), or by towing anything behind the vehicle. Do not drive up hills or run into fixed objects, which can cause the wheels to stop spinning while power is still being supplied to the motors. If breaker continually trips, please contact our Service Center.
Short operating time (less than 1 hours per charge)	Undercharged battery	A new battery should have been charged for at least 12 hours before using the vehicle for the first time. After that, it must be recharged the battery for at least 10-12 hours after each use. Never charge longer than 15 hours. Check all connectors; make sure the charger is plugged into the wall. Make sure the power flow to the outlet is on.
	Overcharged battery	Never charge battery longer than 15 hours. If you think the battery maybe damage due to overcharging, contact our Service Center for testing.
	Old battery will not accept a full charge	Even with proper care, a rechargeable battery does not last forever. Average battery life is 1 to 3 years depending on vehicle use and use conditions. Replace the battery with a new KID MOTORZ 12 volt rechargeable battery. Do not substitute parts. Please contact our Service Center to get a replacement battery.

12

Trouble Shooting I

Trouble Shooting

13

Trouble Shooting II

Problem	Possible Cause	Solution
Vehicle is sluggish	Undercharged battery	A new battery should have been charged for at least 12 hours before using the vehicle for the first time. After that, it must be recharge the battery for at least 10-12 hours after each use. Never charge longer than 15 hours. Check all connectors; make sure the charger is plugged into the wall. Make sure the power flow to the outlet is on.
	Battery needs charging	Be sure to charge the battery after each use.
	Old battery will not accept a full charge	Even with proper care, a rechargeable battery does not last forever. Average battery life is 1 to 3 years depending on vehicle use and use conditions. Replace the battery with a new KID MOTORZ 12 volt rechargeable battery. Do not substitute parts. Please contact our Service Center to get a replacement battery.
	Vehicle is overloaded	Only one rider at a time, follow the 30kg (66 lbs) weight capacity and don't tow anything behind the vehicle.
	Driving conditions are too stressful	Use only on a generally level ground.
Intermittent vehicle operation	Loose wire or connector	Check all wires around the motors and all connectors to make sure they are tight.
	Motor or electrical switch damage	Contact our Service Center for diagnosis and repair.
When the accelerator is pressed, the vehicle won't run without a push	Loose wire or connector	Check all wires around the motors and all connectors to make sure they are tight.
	"Dead Spot" on motor	Contact our Service Center for diagnosis and repair.
Motor gear box makes a loud grinding or clacking noise	Broken gears	Contact our Service Center for diagnosis and repair.
Charger get warm during use	This is normal and should not be concern.	No action required.
Battery makes gurgling or sizzling noise while charging	Some noise and swelling is normal and should not be a concern	No action required. If the battery does not make noise while charging. It does not mean it isn't accepting the charging.

If, after reviewing the Problems and Solutions Guide, the vehicle still fails to operate, please contact our Service Center at 1-909-643-9359

Note! For faster service when calling Consumer Relations, completely charge the battery before calling and have the following available by the phone:

Vehicle.

Vehicle model number.

Vehicle production run number.

(The warranty and customer service contact in this manual only apply in the United States and Canada.)

Label Decoration

Proper label application will help to keep the labels looking their best! When applying labels, keep the following guidelines in mind:

- Wash your hands before applying the labels.
- Before applying the labels, wipe the surface of the vehicle with a clean, dry cloth to remove any dust or oils.
- Place the labels exactly as shown in the illustrations.
- For best results, avoid repositioning a label once it has been applied to the vehicle.
- After applying a label, rub the label firmly with a clean, dry cloth to make sure the label is adhered to your vehicle. Start at the center of a label, and smooth towards the outer edges to remove air bubbles.

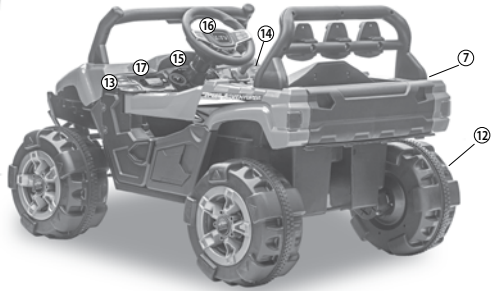
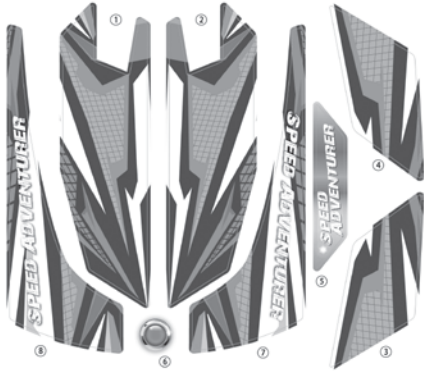

Speed Adventurer UTV

BATTERY-POWERED RIDE-ON

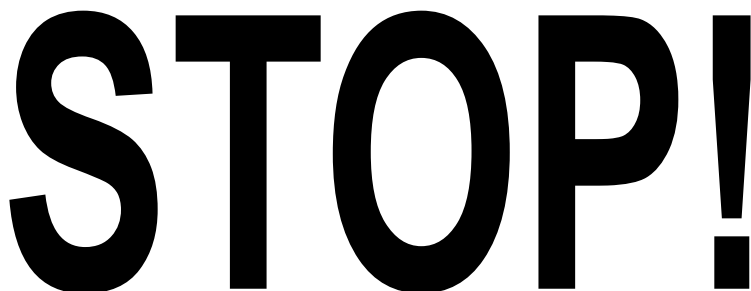

STOP!

DO NOT RETURN TO STORE
WE ARE HERE TO HELP

This product cannot be returned for a refund
after it has been unpacked and used.

Call us **1-909-643-9359** or

fax us **1-909-869-5945** or

email us customerservice@funcreation.net
for assistance and information
from our trained technical staff.